

Product data sheet

Characteristics

2S1F

TRANSFORMER DRY 2KVA

240X480V-120/240V

Product availability : Stock - Normally stocked in distribution facility



Main

Product or component type	Dry Sealed Transformer
Primary to Secondary Voltage	240 x 480 V 120/240 V
Full Capacity Taps	0

Complementary

Enclosure Code	9A
Phase	1 phase
Power Rating	2 kVA
Temperature rise	115 °C
Height	9.56 in (242.82 mm)
Width	8.68 in (220.47 mm)
Depth	6.56 in (166.62 mm)
Enclosure mounting	Wall mounted
Net Weight	39.1 lb(US) (17.74 kg) 39.11 lb(US) (17.74 kg)
Enclosure material	Painted sheet steel

Environment

Enclosure Type	NEMA 3R
Insulation temperature	356 °F (180 °C)
Product certifications	CSA UL Listed CULus

* Price is "List Price" and may be subject to a trade discount – check with your local distributor or retailer for actual price.

Ordering and shipping details

Category	16277 - RESIN LVGP XFMR
Discount Schedule	PE2
GTIN	00785901019886
Nbr. of units in pkg.	1
Package weight(Lbs)	49.2 lb(US) (22.32 kg)
Returnability	Yes
Country of origin	MX

Packing Units

Package 1 Height	9.90 in (25.146 cm)
Package 1 width	11.10 in (28.194 cm)
Package 1 Length	12.50 in (31.750 cm)

Offer Sustainability

Sustainable offer status	Green Premium product
California proposition 65	WARNING: This product can expose you to chemicals including: Phenyl glycidyl ether, which is known to the State of California to cause cancer and birth defects or other reproductive harm. For more information go to www.P65Warnings.ca.gov
RECh Regulation	RECh Declaration
RECh free of SVHC	Yes
EU RoHS Directive	Compliant EU RoHS Declaration
Toxic heavy metal free	Yes
Mercury free	Yes
RoHS exemption information	Yes
China RoHS Regulation	China RoHS declaration Pro-active China RoHS declaration (out of China RoHS legal scope)
Environmental Disclosure	Product Environmental Profile
PVC free	Yes

Contractual warranty

Warranty	18 months
----------	-----------

Approximate Dimensions

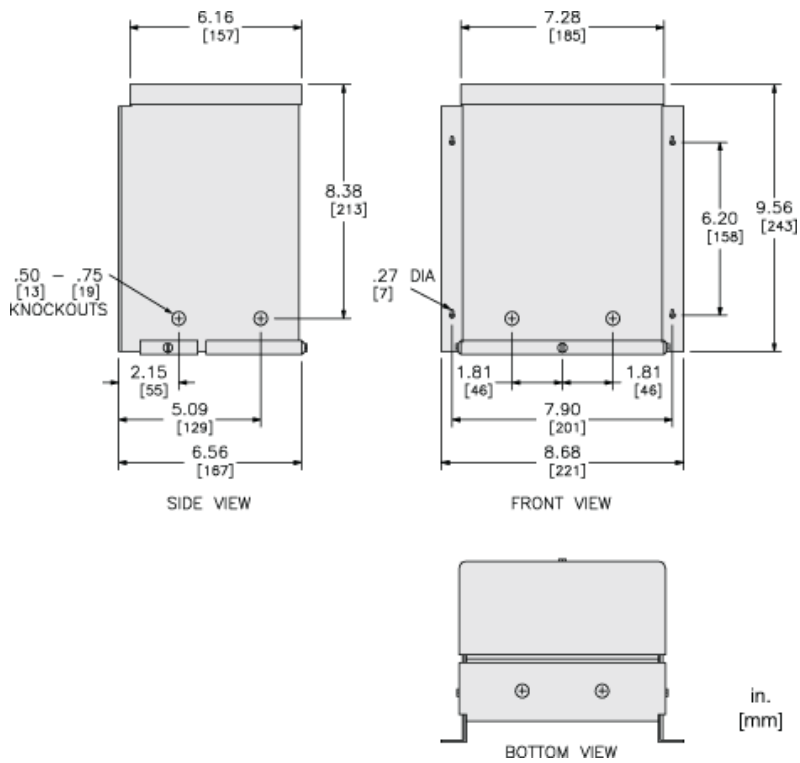

Wiring Diagrams
